



1 Radley Terrace, Halam, Newark, NG22 8AB

Offers In Region Of £195,000

Tel: 0115 9336666

 **RICHARD
WATKINSON**
PARTNERS
Surveyors, Estate Agents, Valuers, Auctioneers

- End Terraced Period House
- Popular Village Location
- 2 Reception Rooms
- 2 Double Bedrooms
- Pretty Cottage Style Garden
- No Upward Chain
- Well Appointed Accommodation
- Fitted Breakfast Kitchen
- 1s Floor Bathroom
- Off Road Parking For 1

Offered for sale with the advantage of no upward chain. This attractive end terraced period property occupies a central and poplar village location and provides well appointed accommodation which in brief comprises: a useful porch, two well proportioned reception rooms and a fitted kitchen and two first floor double bedrooms and a bathroom.

Outside there is useful off street parking for one car and an attractive fully enclosed cottage style garden featuring a small shaped lawn and attractive seating areas.

Viewing highly recommended.

ACCOMMODATION

A uPVC double glazed entrance door leads into the entrance porch with a uPVC double glazed window to the side aspect, a polycarbonate roof, tiled flooring and glazed French doors into the dining room.

DINING ROOM

A well proportioned room with parquet flooring, a central heating radiator, a uPVC double glazed window to the side aspect, staircase rising to the first floor, an arch into the lounge and a door into the kitchen.

KITCHEN

Fitted with a range of base and wall units with rolled edge worktops and tiled splashbacks, an inset stainless steel one and a half bowl single drainer sink with mixer tap and space for appliances including plumbing for a washing machine and a gas cooker point. There is a slate effect tiled floor, a central heating radiator and a uPVC double glazed window to the side aspect, space for a gas cooker with chimney extractor hood over.

LOUNGE

With parquet flooring, a central heating radiator, understairs storage, a uPVC double glazed window to the side aspect and double glazed double French doors onto the garden. There is a feature chimney breast with raised hearth with potential for an open fire.

FIRST FLOOR LANDING

With an access hatch to the roof space.

BEDROOM ONE

A pleasant dual aspect double bedroom with stripped wooden flooring, uPVC double glazed windows to two elevations, a central heating radiator and a range of fitted wardrobes with hanging rail and storage above.

BEDROOM TWO

With stripped wooden floorboards, a central heating radiator and a uPVC double glazed window to the side aspect.

BATHROOM

Fitted in white with a dual flush toilet, a pedestal wash basin with mixer tap and a freestanding rolled top bath with mixer tap and shower attachment. There is a traditional style chrome towel radiator plus tiling for splashbacks, a uPVC double glazed window and an airing cupboard housing the Worcester central heating boiler and the foam insulated hot water cylinder.

PARKING

Off street parking is provided for one car.

GARDENS

A delightful and fully enclosed cottage style garden provides paved patio and gravelled seating plus a small shaped lawn edged with well stocked planted beds and borders.

COUNCIL TAX

The property is registered as council tax band C.

VIEWINGS

By appointment with Richard Watkinson & Partners.





Approximate Gross Internal Area
767 sq ft - 71 sq m

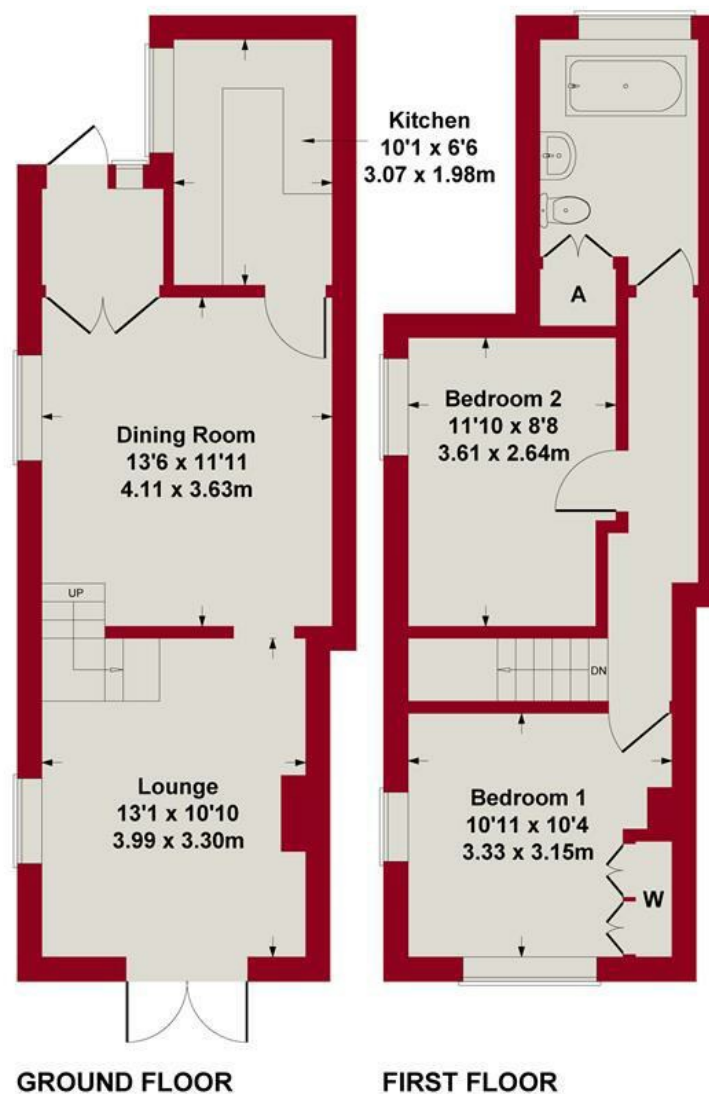

Whilst every attempt has been made to ensure the accuracy of the floor plan contained here, measurements of doors, windows, rooms and any other items are approximate and no responsibility is taken for any error, omission, or mis-statement. This plan is for illustrative purposes only and should be used as such by any prospective purchaser or tenant. The services, systems and appliances shown have not been tested and no guarantee as to their operability or efficiency can be given.
 Copyright V360 Ltd 2024 | www.houseviz.com



Energy Efficiency Rating		
	Current	Potential
Very energy efficient - lower running costs		
(92 plus) A		89
(81-91) B		
(69-80) C		
(55-68) D		
(39-54) E		
(21-38) F		
(1-20) G		
Not energy efficient - higher running costs		
		63
England & Wales		EU Directive 2002/91/EC

Environmental Impact (CO ₂) Rating		
	Current	Potential
Very environmentally friendly - lower CO ₂ emissions		
(92 plus) A		
(81-91) B		
(69-80) C		
(55-68) D		
(39-54) E		
(21-38) F		
(1-20) G		
Not environmentally friendly - higher CO ₂ emissions		
England & Wales		EU Directive 2002/91/EC



These particulars, whilst believed to be accurate are set out as a general outline only for guidance and do not constitute any part of an offer or contract. Intending purchasers should not rely on them as statements of representation of fact, but must satisfy themselves by inspection or otherwise as to their accuracy. No person in this firm's employment has the authority to make or give any representation or warranty in respect of the property. Any fixtures and fittings not mentioned in these details are excluded from the sale price. No services or appliances which may have been included in these details have been tested by the selling agent and therefore cannot be guaranteed to be in good working order.

As part of the service we offer we may recommend ancillary services to you such as mortgage advice, solicitors and surveyors which we believe will help with your property transaction. We wish to make you aware that should you decide to proceed we may receive a referral fee or equivalent. This could be a fee, commission, payment or other reward. We will not refer your details unless you have provided consent for us to do so. You are not under any obligation to provide us with your consent or to use any of these services. You are also free to choose an alternative provider.

Thinking of selling? For a FREE no obligation quotation call 0115 9336666



RICS



Richard Watkinson & Partners is the trading name of Richard Watkinson Ltd.
Registered in England. Ltd Registration number: 07140024

34 Main Road,
Radcliffe On Trent NG12 2FH
Tel: 0115 9336666
Email: radcliffeontrent@richardwatkinson.co.uk

**RICHARD
WATKINSON
PARTNERS**

Surveyors, Estate Agents, Valuers, Auctioneers